

**DOOR KEYPAD
MOUNTING
INSTRUCTION**

N X
FREQUENCY CONVERTERS

Door Keypad – Mounting instructions

The Door Keypad is used for standard control keypad purposes and it is installed on the door of a switchgear cabinet.

For the installation, you need the following parts (see the picture below):

- a) Door Keypad **(1)**
- b) 8 screws [M4x8] attached to the door keypad kit. **(2)**
- c) 8 washers [4mm] **(2)**
- d) Connection cable [Vacon] **(3)**
- e) Tools to make the opening for the keypad and holes for the screws in the cabinet door

MAKE SURE THAT YOU HAVE RECEIVED ALL NECESSARY PARTS!

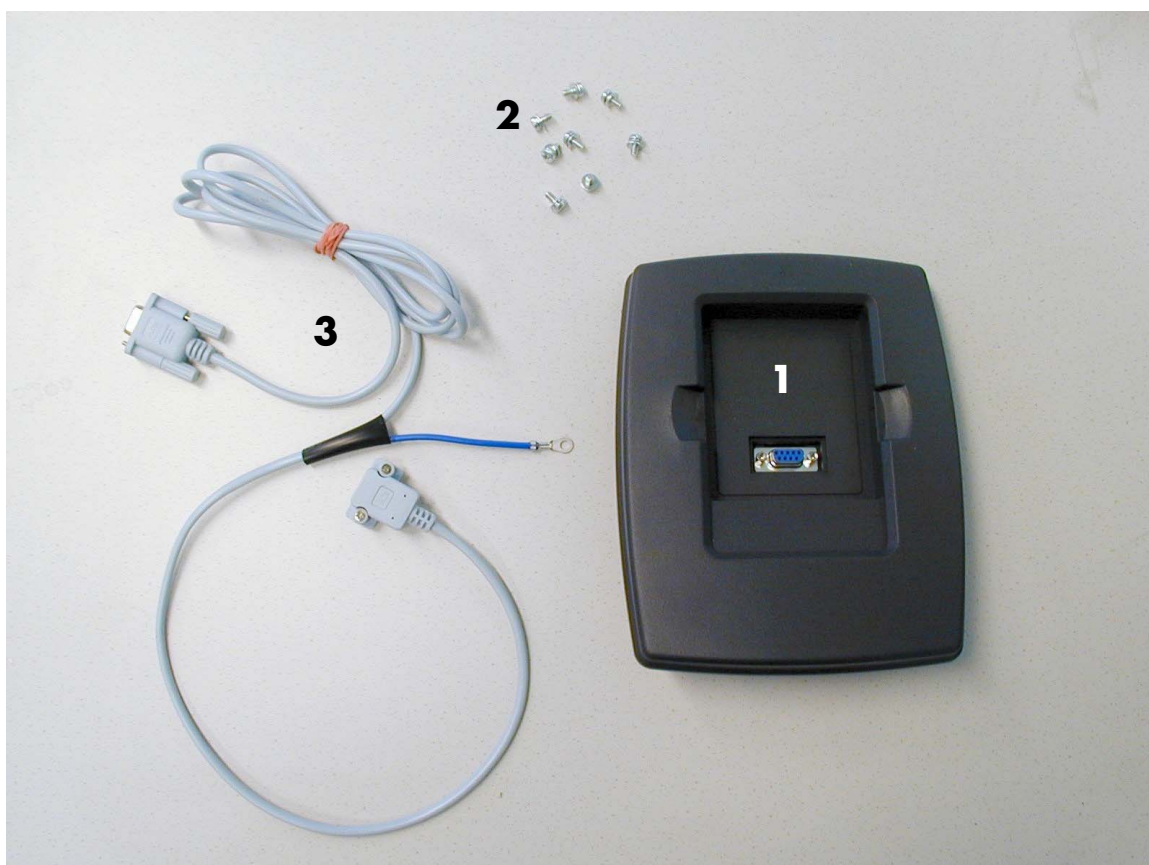

Figure 1. Parts of Vacon NX Door Keypad

Mounting procedure:

1. Make an opening in the cabinet door for the control keypad using the keypad dimensions (real scale) in Appendix 1. The dimensions of the opening shall be 144 (± 3) mm x 115 (± 3) mm.
2. Make also the holes for the screws [M4x8] using the real scale dimensions of Appendix 1.
3. Place the control keypad (1) in the opening so that the screw holes you made in the cabinet door meet the bushings on the backside of the control keypad.
4. Fix the control keypad on the cabinet door by tightening the screws (2). Don't forget to place the washers (3) between the door and the screws. The tightening torque is 1.5 Nm.
5. Connect the Vacon cable (4) to the terminal of the control keypad, see Figures 2 and 3 below
6. Attach the earthing cable, see the Figures below.
7. Make a sufficiently wide opening for the earthing cable by cutting the grid of the cable cover as wide as necessary **in FR8**. Attach the cable cover. See Figure 4 below.
8. Vacon NX Door Keypad is now ready to use.

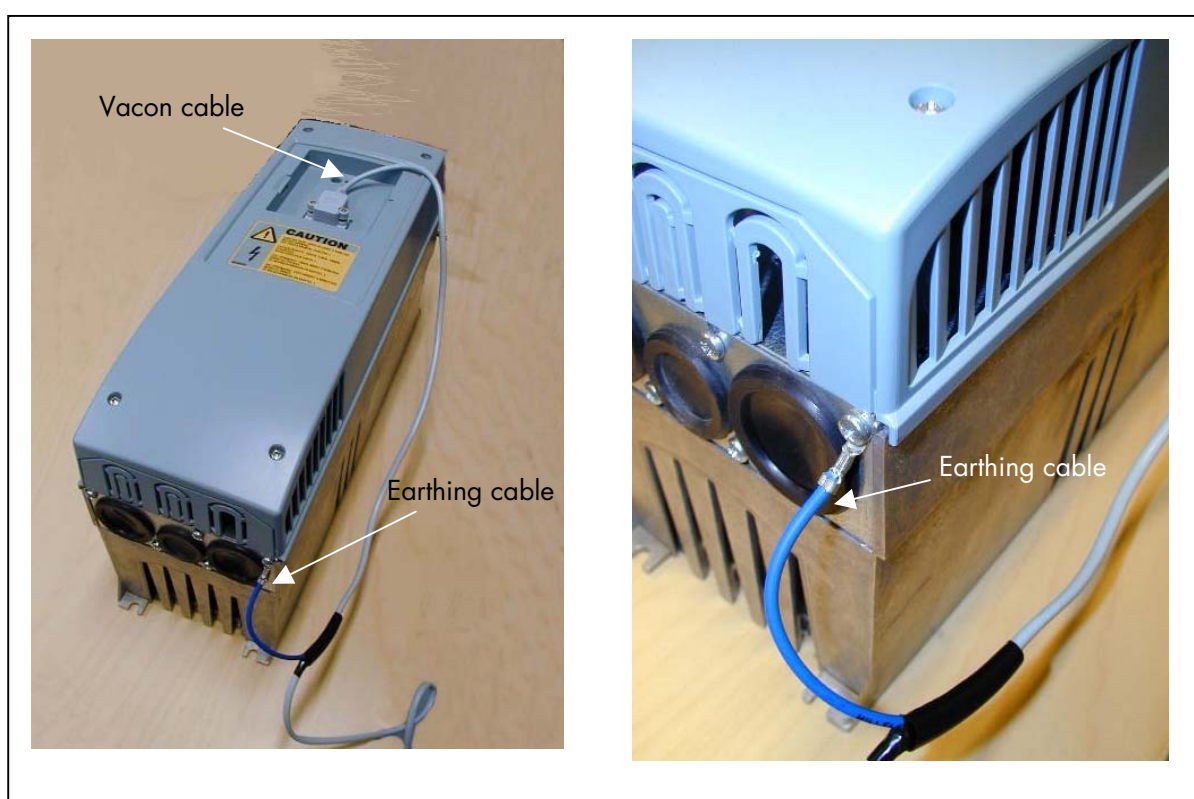

Figure 2. Connection of Vacon cable and the earthing cable, FR4 – FR7

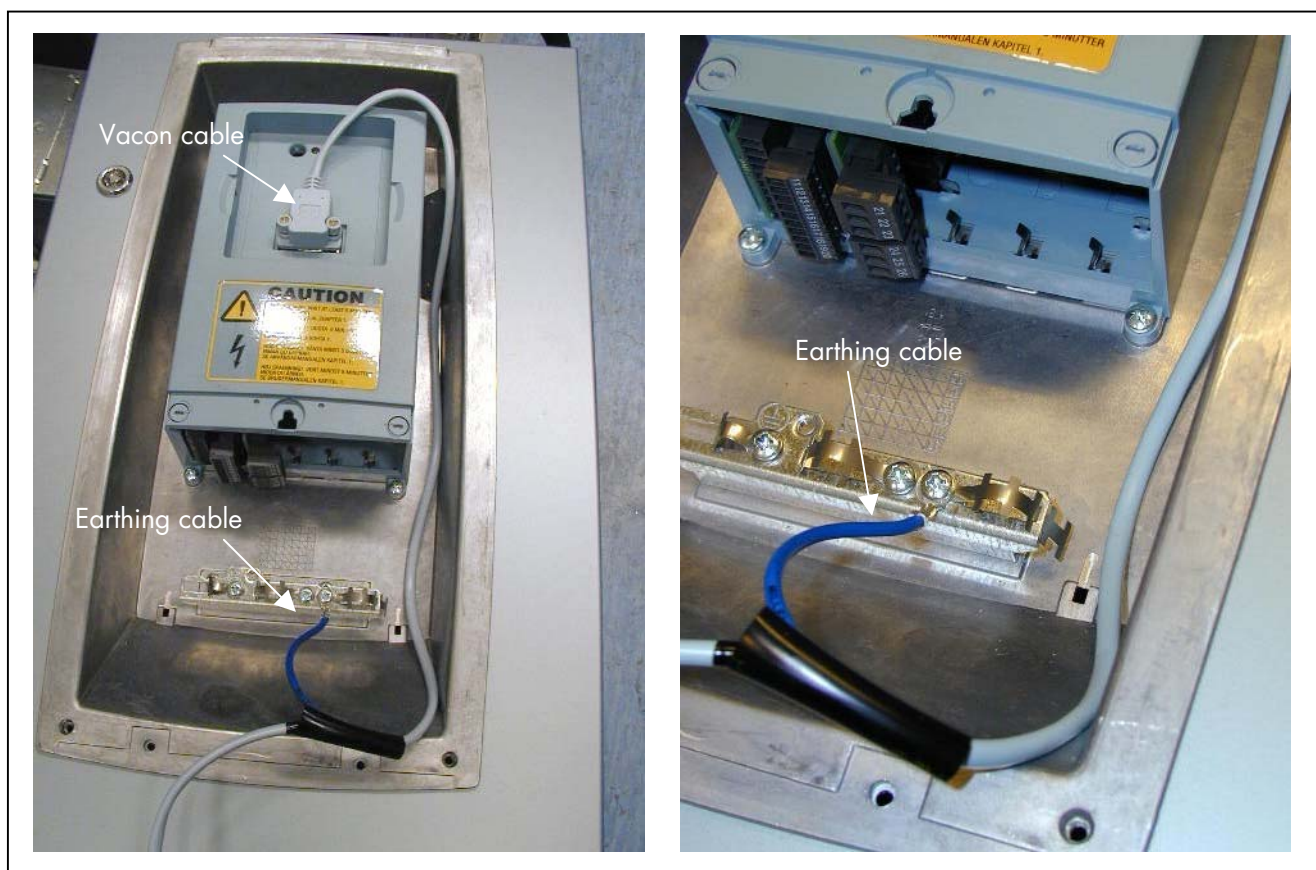
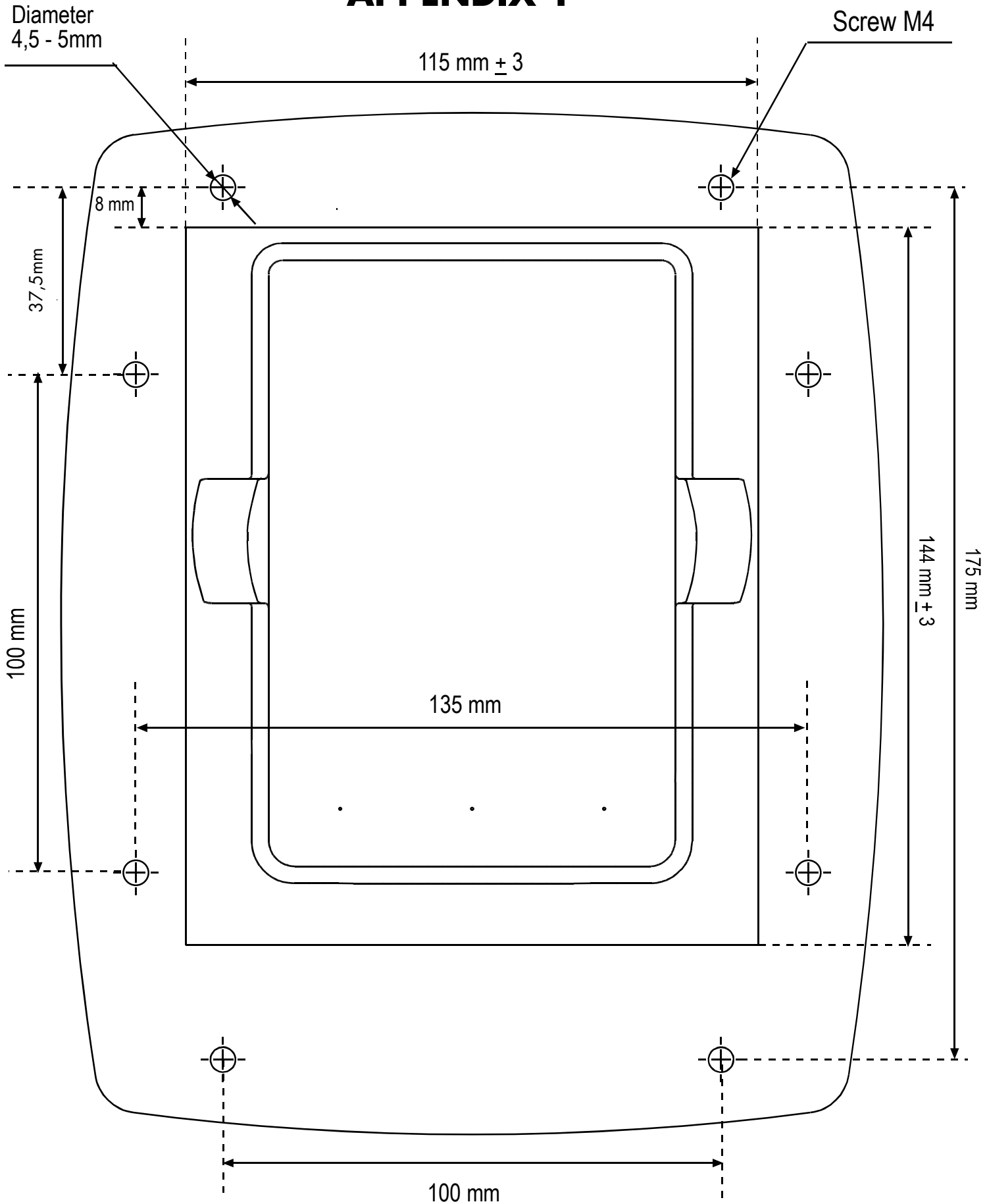

Figure 3. Connection of Vacon cable and the earthing cable, FR8



Figure 4. Attach the cable cover after connecting the earthing cable, FR8

APPENDIX 1

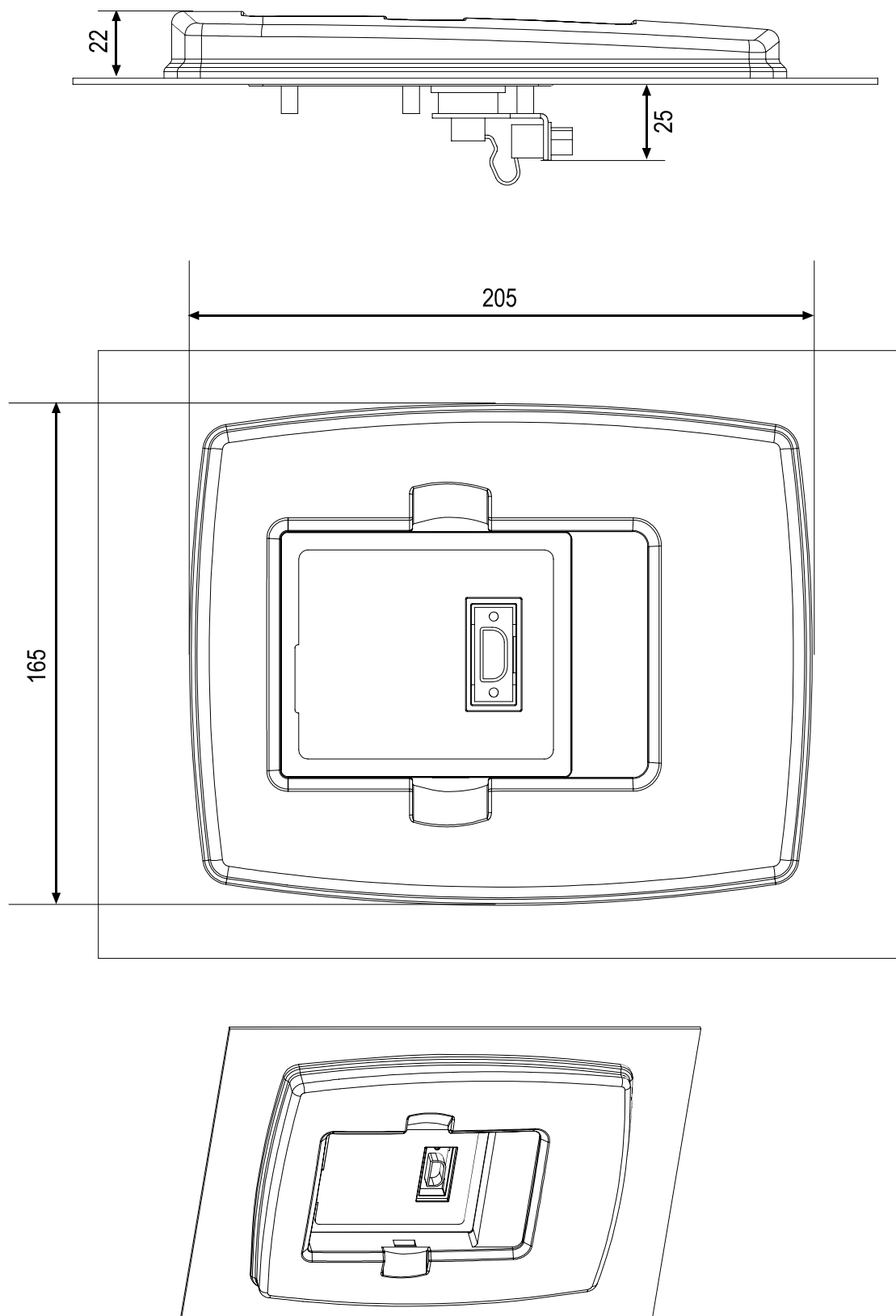

APPENDIX 2

ud757.doc
21.11.01 10:45

Vacon Plc
P.O.Box 25
Runsorintie 7
65381 VAASA
FINLAND

Tel: +358-(0)201-2121
Fax: +358-(0)201-212 205
24-hour service: +358-(0)40-8371 150